

WRH

Product Discontinued

Vandal Resistant Wet Location Remote Heads

The Wet Location remote heads provide the quality construction of the standard vandal series enhanced with a 1/8" thick impact resistant injection molded polycarbonate shield. Ideal for wet locations and NEMA 4X requirements with an IP 66 rating, and for vandal resistant applications.



CONSTRUCTION

- 18-gauge cold rolled powder coated steel back mounting plate, white or black finish
- Rubber O-Ring gasket retained in a groove for wet locations
- Universal Mounting pattern for wall or ceiling mounting
- Polycarbonate protective lens shroud protects lamps from accidental or intentional abuse
- Stainless steel tamper resistant Torx head screws
- Suitable for use in schools, public areas, detention facilities, and anywhere that vandalism or abuse is a concern

DIMENSIONS

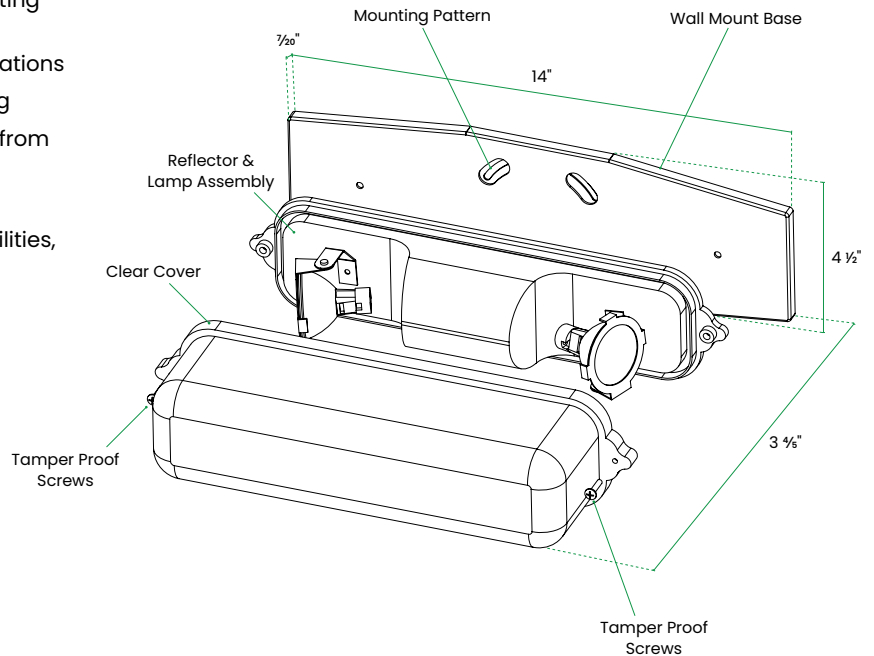

ORDERING GUIDE

WRH-L127-W

MODEL	LAMP SELECTION			FINISH
	6V LAMPS	12V LAMPS	24V LAMPS	
WRH	L65 6V 5W LED	L125 12V 5W LED	L245 24V 5W LED	W White (Standard) B Black
	L67 6V 7W LED	L127 12V 7W LED	L247 24V 7W LED	
WRH				

Fill in fields from categories above and complete type and part number.

Type No:

Full Part No: