



PERFORMANCE

OUTPUT	DISTRIBUTION	NOMINAL			
		STANDARD TILE*			HE TILE**
		LUMEN OUTPUT	INPUT WATTS	EFFICACY	EFFICACY
L VH VERY HIGH	LAMBERTIAN	4734 lm	53 W	89 lm/W	98 lm/W
LH HIGH	LAMBERTIAN	3704 lm	40 W	92 lm/W	101 lm/W
LS STANDARD	LAMBERTIAN	2611 lm	28 W	93 lm/W	103 lm/W

Based on static white 3500K, Arctic White felt (AWF). For the complete photometric data of this fixture go to page 3.
 *Standard tile : 90% reflective surface.
 ** High Efficiency reflector tile : 98% reflective surface.

ACOUSTIC COLOR OPTIONS

Standard colors



Premium colors



a·light

Lean

Sustainable - Indirect - Recessed Lay-in

Lean is a 2'x2' acoustic lay-in that delivers highly efficient Lambertian light for any grid-ceiling application. The dynamic design brings visual excitement, spacial depth, improved acoustics and configurability to the grid ceilings. Using on-site ceiling tiles, light-weight collapsible and recyclable elements, Lean delivers great embodied carbon savings.

- 23% faster installation time compared to typical 2'x2' lay-ins
- Perfect for existing and new construction applications
- Configurable single units that can be clustered to create dynamic ceiling landscapes
- 30 acoustic panel color options
- Utilizes project ceiling tiles as reflective surface

SUSTAINABILITY

- Aluminum body - 60% recycled -100% recyclable
- Felt Frame - 40% recycled PET -100% recyclable
- Declare Red List Approved - Red List free electrical wires containing no PVC/FEP
- Up to 88% reduced shipping volume & 80% reduced weight greatly reduces carbon footprint
- Reduced number of components and design for disassembly aids recycling and re-use
- 4.1lbs total weight & collapsible for easy installation by a single person
- Reduced volume & fully recycled/recyclable and compostable packaging material; easy jobsite manipulation and disposal

DIMENSIONS

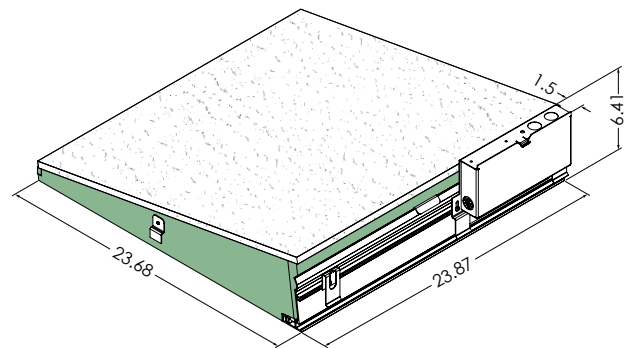

LIGHTING DESIGN AWARDS





PROJECT INFORMATION

Project Info

Type

Date

Quantity

Need help? Don't see what you need?
 We know that having so many options can be overwhelming. Please reach out to our factory for any specific request or questions you have. Our talented Design Assist team is here to make the process move smoothly.

PERFORMANCE AT 3500K

OUTPUT	DISTRIBUTION	NOMINAL			
		STANDARD TILE*			HE TILE**
		LUMEN OUTPUT	INPUT WATTS	EFFICACY	EFFICACY
LVH VERY HIGH	LAMBERTIAN	4734 lm	53 W	89 lm/W	98 lm/W
LH HIGH	LAMBERTIAN	3704 lm	40 W	92 lm/W	101 lm/W
LS STANDARD	LAMBERTIAN	2611 lm	28 W	93 lm/W	103 lm/W

Based on static white 3500K, Arctic White felt (AWF). For the complete photometric data of this fixture go to page 3.
 *Standard tile : 90% reflective surface.
 ** High efficiency reflector tile : 98% reflective surface.

A CEILING TILE IS NOT PROVIDED WITH THIS FIXTURE

Lean has been designed to use a ceiling tile that is already on site. If a high quality 90%+ reflective tile is not available for installation, please order a HE tile in the ordering code below.

ORDERING CODE INDIVIDUAL DRIVER LEAN

LEAN

LEAN	POWER SUPPLY	OUTPUT	LED CCT	CRI	VOLTAGE
LEAN	I Individual driver	LS Standard output LH High output LVH Very high output** C_ Custom output*	27 2700K 30 3000K 35 3500K 40 4000K	- 80+ CRI CRI 90+ CRI	U 120V-277V 3 347V*

ACOUSTIC COLOR OPTIONS	DIMMING	EMERGENCY	OPTIONS																																
<p>Standard Colors</p> <table border="0"> <tr> <td> ABF</td> <td> AWF</td> <td> BBF</td> <td> BOF</td> </tr> <tr> <td> BTF</td> <td> BYF</td> <td> CHF</td> <td> NBF</td> </tr> <tr> <td> OBF</td> <td> PGF</td> <td> REF</td> <td> SGF</td> </tr> <tr> <td> TGF</td> <td> ZFF</td> <td></td> <td></td> </tr> </table> <p>Premium Colors</p> <table border="0"> <tr> <td> BGF</td> <td> BKF</td> <td> DBF</td> <td> DTF</td> </tr> <tr> <td> DYF</td> <td> GGF</td> <td> LBF</td> <td> LGF</td> </tr> <tr> <td> MGF</td> <td> OAF</td> <td> PBF</td> <td> PNF</td> </tr> <tr> <td> PPF</td> <td> SBF</td> <td> TOF</td> <td> TPF</td> </tr> </table> <p>* Felt color will influence output, please consult LLF table for more details</p>	ABF	AWF	BBF	BOF	BTF	BYF	CHF	NBF	OBF	PGF	REF	SGF	TGF	ZFF			BGF	BKF	DBF	DTF	DYF	GGF	LBF	LGF	MGF	OAF	PBF	PNF	PPF	SBF	TOF	TPF	<p>D Standard 0-10V dimming¹</p> <p>D4 DALI dim-to-off²</p> <p>NAIR nLight@AIR (dim-to-off)^{3/4}</p> <p>NWIR nLight@Wired (dim-to-off)⁴</p> <p>¹ Dimming to 1% stated for standard 0-10V dimming specified. ² DALI not available in 347V. ³ nLight AIR completely integrated into fixture in 120-277V. Not available with Emergency Circuit. ⁴ nLight in 347V is only offered with external power packs (provided by others). ⁵ nLight Wired is only offered with external power packs (provided by others).</p>	<p>E_ Emergency - battery*</p> <p>EC Emergency - circuited**</p> <p>* Remote mounted battery provided, to be wired by electrician on site. Includes remote box. ** Not available with nLight Air</p>	<p>HE High Efficiency reflector tile*</p> <p>SM Seismic application</p> <p>* Lean is designed to use the existing standard acoustic tile. If needed, an 98% reflective surface can be ordered instead of standard ceiling tile for maximum efficiency.</p>
ABF	AWF	BBF	BOF																																
BTF	BYF	CHF	NBF																																
OBF	PGF	REF	SGF																																
TGF	ZFF																																		
BGF	BKF	DBF	DTF																																
DYF	GGF	LBF	LGF																																
MGF	OAF	PBF	PNF																																
PPF	SBF	TOF	TPF																																

The ceiling tile is not provided with this fixture. Please ensure high quality ceiling tiles are available for installation of the Lean.



LIGHT DISTRIBUTION

OUTPUT POWER

LVH: Very high output - 53W
 LH: High output - 40W
 LS: Standard output - 28 W
 C: Custom tuned output - Contact Design Assist

PERFORMANCE AT 3500K

OUTPUT	DISTRIBUTION	NOMINAL			
		STANDARD TILE*			HE TILE**
		LUMEN OUTPUT	INPUT WATTS	EFFICACY	EFFICACY
LVH VERY HIGH	LAMBERTIAN	4734 lm	53 W	89 lm/W	98 lm/W
LH HIGH	LAMBERTIAN	3704 lm	40 W	92 lm/W	101 lm/W
LS STANDARD	LAMBERTIAN	2611 lm	28 W	93 lm/W	103 lm/W

Based on static white 3500K, Arctic White felt (AWF).
 *Standard tile : 90% reflective surface.
 ** High efficiency reflector tile : 98% reflective surface.

PHOTOMETRIC DATA

INDIRECT LAMBERTIAN
 LH - 3500K - Lambertian

Lumens: 3704 lm
 Input watts: 40 W
 Efficacy: 92 lm/W

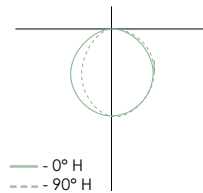

INDIRECT LAMBERTIAN - HIGH EFFICIENCY
 LHHE - 3500K - Lambertian

Lumens: 4074 lm
 Input watts: 40 W
 Efficacy: 101 lm/W

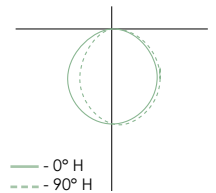

LIGHT LOSS FACTORS CRI (LLF)

OUTPUT	CCT	LLF RATIO		INDIRECT LAMBERTIAN	
		CRI 80+	CRI 90+	CRI 80 +	CRI 90 +
LVH (very high)	4000k	102.1%	90.2%	4833 lm	4270 lm
	3500k	100%	87.3%	4734 lm	4133 lm
	3000k	96.2%	82.4%	4554 lm	3901 lm
	2700k	92.5%	78.1%	4379 lm	3697 lm
LH (high)	4000k	102.1%	90.2%	3782 lm	3341 lm
	3500k	100%	87.3%	3704 lm	3234 lm
	3000k	96.2%	82.4%	3563 lm	3052 lm
	2700k	92.5%	78.1%	3426 lm	2893 lm
LS (standard)	4000k	102.1%	90.2%	2666 lm	2355 lm
	3500k	100.0%	87.3%	2611 lm	2279 lm
	3000k	96.2%	82.4%	2512 lm	2151 lm
	2700k	92.5%	78.1%	2415 lm	2039 lm

Factors above for reflective Arctic White felt (AWF) and 90% reflective ceiling tile.

LIGHT LOSS FACTORS FELT COLOR (LLF)

FELT COLOR		LLF RATIO	LS (STANDARD)	LH (HIGH)	LVH** (VERY HIGH)	LSHE (STANDARD HE*)	LHHE (HIGH HE*)	LVHHE ** (VERY HIGH HE*)
ARCTIC WHITE	AWF	100%	2611 lm	3704 lm	4734 lm	2872 lm	4074 lm	5207 lm
SILVER GRAY	SGF	85%	2219 lm	3148 lm	4024 lm	2441 lm	3463 lm	4426 lm
DAISY YELLOW	DYF	96%	2507 lm	3556 lm	4545 lm	2757 lm	3911 lm	4999 lm
SKY BLUE	SBF	74%	1932 lm	2741 lm	3503 lm	2125 lm	3015 lm	3853 lm
AZURE BLUE	ABF	72%	1890 lm	2667 lm	3408 lm	2068 lm	2934 lm	3749 lm
PEAR GREEN	PGF	77%	2010 lm	2852 lm	3645 lm	2212 lm	3137 lm	4010 lm
LIME GREEN	LGF	76%	1984 lm	2815 lm	3598 lm	2183 lm	3097 lm	3957 lm
RED	REF	69%	1802 lm	2556 lm	3266 lm	1982 lm	2811 lm	3593 lm
TITANIUM GRAY	TGF	70%	1828 lm	2593 lm	3314 lm	2010 lm	2852 lm	3645 lm
LIGHT BEIGE	LBF	83%	2167 lm	3074 lm	3929 lm	2384 lm	3382 lm	4322 lm
BATTLESHIP GRAY	BTF	68%	1775 lm	2519 lm	3219 lm	1953 lm	2771 lm	3541 lm
CHARCOAL	CHF	67%	1749 lm	2482 lm	3172 lm	1924 lm	2730 lm	3489 lm
BASIC BLACK	BBF	66%	1723 lm	2445 lm	3124 lm	1896 lm	2689 lm	3437 lm
OAK BROWN	OAF	67%	1749 lm	2482 lm	3172 lm	1924 lm	2730 lm	3489 lm
PEANUT BROWN	PBF	74%	1932 lm	2741 lm	3503 lm	2125 lm	3015 lm	3853 lm
BARK BROWN	BKF	70%	1828 lm	2593 lm	3314 lm	2010 lm	2852 lm	3645 lm
BANANA YELLOW	BYF	89%	2324 lm	3297 lm	4213 lm	2556 lm	3626 lm	4635 lm
MOSS GREEN	MGF	76%	1984 lm	2815 lm	3598 lm	2183 lm	3097 lm	3958 lm
GRASS GREEN	GGF	69%	1802 lm	2556 lm	3266 lm	1982 lm	2811 lm	3593 lm
DENIM BLUE	DBF	68%	1775 lm	2519 lm	3219 lm	1953 lm	2771 lm	3541 lm
NAVY BLUE	NBF	67%	1749 lm	2482 lm	3172 lm	1924 lm	2730 lm	3489 lm
OCEAN BLUE	OBF	66%	1723 lm	2445 lm	3124 lm	1896 lm	2689 lm	3437 lm
PLUM PURPLE	PPF	67%	1749 lm	2482 lm	3172 lm	1924 lm	2730 lm	3489 lm
TULIP PURPLE	TPF	68%	1775 lm	2519 lm	3219 lm	1953 lm	2771 lm	3541 lm
ZINFANDEL	ZFF	67%	1749 lm	2482 lm	3172 lm	1924 lm	2730 lm	3489 lm
PINOT NOIR	PNF	68%	1775 lm	2519 lm	3219 lm	1953 lm	2771 lm	3541 lm
BUBBLE GUM	BGF	78%	2037 lm	2889 lm	3693 lm	2240 lm	3178 lm	4062 lm
TANGERINE ORANGE	TOF	82%	2141 lm	3037 lm	3882 lm	2355 lm	3341 lm	4270 lm
BLOOD ORANGE	BOF	75%	1958 lm	2778 lm	3551 lm	2154 lm	3056 lm	3906 lm
DARK TEAL GREEN	DTF	66%	1723 lm	2445 lm	3124 lm	1896 lm	2689 lm	3437 lm

Factors above for 80CRI.
 *HE : high efficiency reflector tile
 **LVH and LVHHE : only available with integral driver

LEAN DIMENSIONS

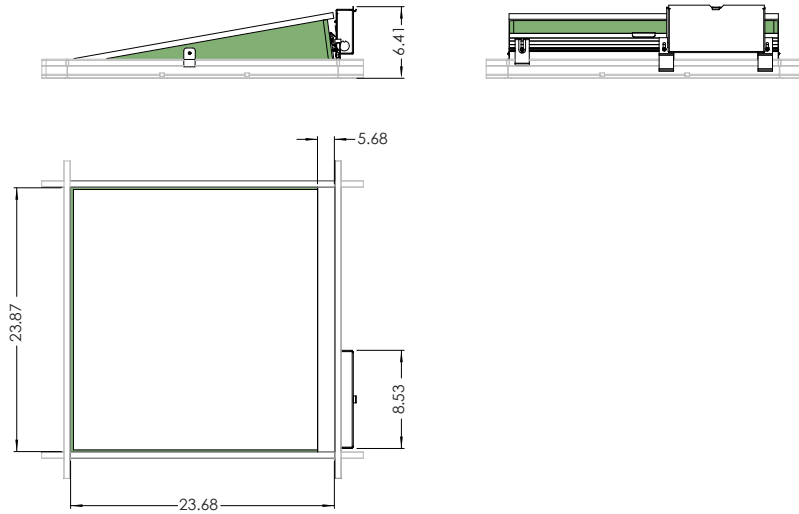

Ceiling grid provided by others
 For back to back configuration, the driverbox needs to be moved to another t-bar.

NLIGHT® DIMENSIONS

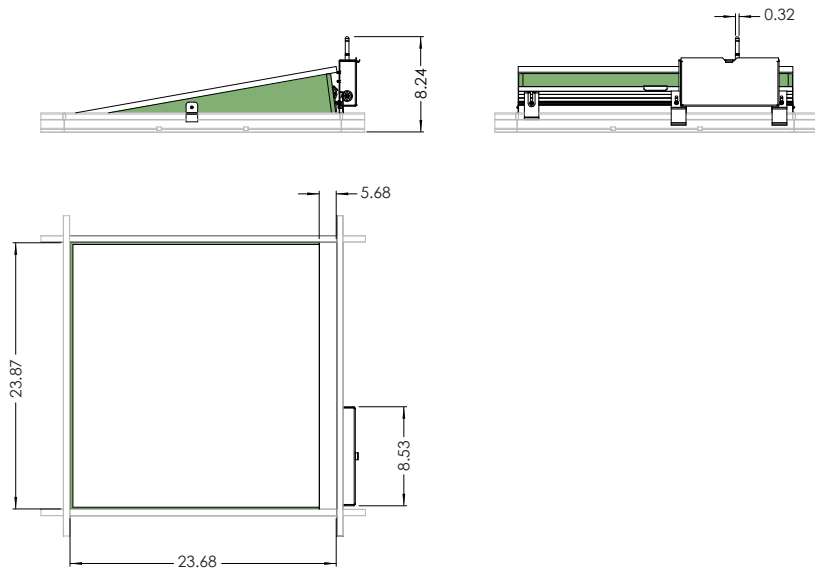

Ceiling grid provided by others

HIGH EFFICIENCY REFLECTOR TILE DIMENSIONS

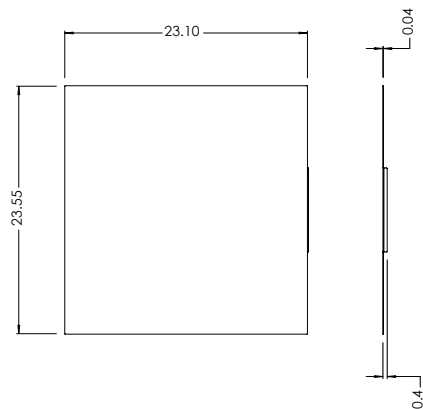

EMERGENCY BATTERY BOX DIMENSIONS

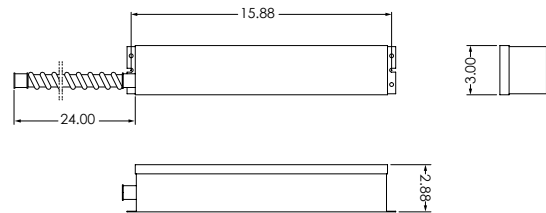

LAY-IN DIMENSIONS

2' nominal length/width for individual fixtures that can be laid into the ceiling together to create various rows and patterns.

OPTICS

The internal lens combined with the reflection of the acoustic tile offers a soft, Lambertian distribution. All photometric data has been generated using USG's Mars ClimaPlus acoustic tile (Reflectance 90.0%) and Silver Grey felt (Reflectance 57.8%).

LED LIGHT SOURCE

Custom manufactured linear board array uses high performance Nichia® LED in combination with a performance driven heat sink technology. Tested in accordance with LM79 and LM-80; L70>60,000hr; operated at reduced output for high efficacy and lumen maintenance. 2700K, 3000K, 3500K, 4000K with 80+ CRI standard; other color temperatures and 90+ CRI available upon request, contact Design Assist. LED color variation maintained at a 3-step MacAdam ellipse (SDCM 3x). LEDs are available in Standard, High and Very High outputs. Refer to photometry for delivered lumens. Custom output available in the range 25% to 125% of high output, contact Design Assist.

LED DIMMING DRIVER

Factory tuned constant current electronic 0-10V control dimming driver is standard. Specification grade dimming down to 1%. Driver life of 50,000 hrs with ambient operating temperature range of -30°C to 50°C, maximum case temperature of 75°C. Electrical specifications at maximum driver load: PF >0.9, THD <20%, >85% Efficiency.

EMERGENCY

This luminaire can be provided with a LED emergency lighting battery pack for both normal and emergency operation, 120-277v only. This emergency pack contains long-life Ni-Cad recyclable battery, 24 hour charger, and converter circuit. Test switch and charge indicator provided. Test button to be remote located within 3 feet of the luminaire, by others in accordance with local code. Emergency mode provides constant power to a nominal 12W LED load for a period of 90 minutes. Please consult the factory for emergency configuration assistance. Our talented Design Assist team is always available for collaboration and specification support.

Emergency circuiting provided as a separate circuit from normal power circuit according to NEC requirements, specify circuit length and location.

NLIGHT® AIR WIRELESS

The API smart sensor is connected to each luminaire in the nLight® AIR network, which can be grouped to control multiple luminaires. The granularity of control with the digital PIR occupancy detection and daylight sensing makes a great solution for any application. Optionally you can order nLight® AIR less sensors for compatibility with an nLight Air wireless system. The rIO and rCMS models are available for integration.

CONTROLS AND SYSTEM NETWORKING OPTIONS

For Both nLight Air and nLight Wired applications, low-profile

remotely ceiling mounted occupancy and daylight sensors are available to deliver high performance control in an architecturally pleasing package.

Integrated nLight® for system networking wired and wireless:

For wired networking via Cat5e, choose an nLight® wired module. The nIO EZ PH and nCM are available for integration as external power packs.

nLight enabled, remote mounted controls provided by others. Please contact an Acuity controls representative for more information.

MOUNTING

T-Bar/Grid Ceiling. 9/16" or 15/16" standard T-Bar or 9/16" slot ceiling. Raw aluminum flange sits on T-Bar and is concealed from view. Seismic accessory kit available.

ACOUSTICS

The felt-like polyester panels are made from at least 40% postconsumer recycled PET bottles and are fully recyclable, No VOCs and formaldehyde free. Fire tested according to ASTM E-84 Class A. The carefully studied hollow core design and the large surface area contribute to lowering the reverberation time in a set environment by absorbing sound frequencies (ideal for human voice range 250Hz to 2000Hz). Material has inherent NRC of 0.75. As results may vary, it is recommended to consult sound professionals for optimal spacing, positioning and quantity of acoustic material for your environment. Due to the dye process, colors may vary from batch to batch. Premium colors require longer lead time.

STRUCTURE

Robust, high quality 60% recycled aluminum extruded support structure for driver and LED-board. 0.040" aluminum internal gear trays. Reflector made out of recycled felt panels which can be folded down to a small pack size. 3.75 lbs approximate fixture weight.

FINISH

Felt panels come in 30 standard swatches. Other colors and custom finish options available, contact Design Assist regarding custom finish requirement.

LISTING

UL Listed under E471278.

WARRANTY

Limited defect-free manufactured equipment warranty provided under normal use and proper storage for five (5) years. LED products (LED boards and drivers) will be covered for five (5) years. Please refer to the full terms and conditions on our website.

SUSTAINABILITY

All packaging material is made of recycled materials compliant to the sustainable forestry initiative. Material transparency certified under the Declare transparency label: ACU-0012. All wires are Red list free, containing no PVC or phthalate. Recycling and disassembly instructions are provided for fixture end of life.